

4420 Stempelführungsbuchse
DIN 9845, Form C

MSTBtec²

Punch guide bushings
DIN 9845, type C

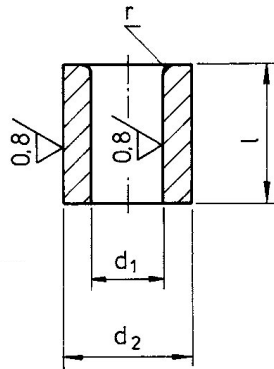

Material: HWS

P= Stück / Normpackung // Pieces/ standard pack

Bestellbeispiel / Order example: d1=2,8mm; l=12mm

Bestell-Nummer / Order number: **4420-2,8x12**

d2 n6	Stufung d1 Step d1	P	d1 H7	l
7	0,1	5	2,1 – 3,0	12
8			3,1 – 4,0	
10			4,1 – 5,0	
12	0,1	5	5,1 – 6,0	16
15			6,1 – 8,0	
18			8,1 – 10,0	
22	0,1	5	10,1 – 12,0	28
26			12,1 – 15,0	
30			15,5 – 18,0	
30	0,5	5	15,5 – 18,0	36