

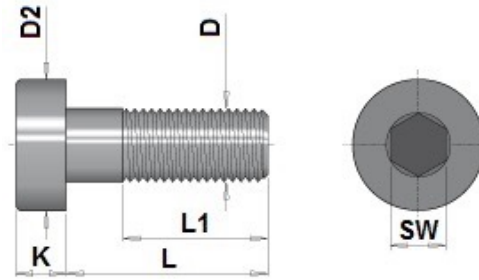

**K6005 Zylinderkopfschraube,
mit niedrigem Kopf**

**Socket head cap screw,
with shallow head**

**Mat.: 8.8 / 800 N/mm²
DIN 7984**



 = Verpackungseinheit / packing unit

Nr. / No.	D	L	D2	L1	K	SW	
K6005 - 4 x 8	M4	8	7	5,9	2,8	2,5	20
10		10		7,9			
12		12		9,9			
16		16		13,9			
18		18		15,9			
20		20		17,9			
25		25		14			
30		30					
35		35					
40		40					
K6005 - 5 x 8	M5	8	8,5	5,6	3,5	3	
10		10		7,6			
12		12		9,6			
14		14		11,6			
16		16		13,6			
18		18		15,6			
20		20		17,6			
22		22		19,6			10
25		25		22,6			
30		30		16			
35		35					
40		40					
K6005 - 6 x 8	M6	8	10	5	4	4	20
10		10		7			
12		12		9			
14		14		11			
16		16		13			
18		18		15			
20		20		17			
22		22		19			10
25		25		22			
30		30		18			
35		35					
40		40					
45		45					
50		50					

Nr. / No.	D	L	D2	L1	K	SW	
K6005 - 8 x 12	M8	12	13	8,3	5	5	10
14		14		10,3			
16		16		12,3			
18		18		14,3			
20		20		16,3			
22		22		18,3			
25		25		22			
30		30					
35		35					
40		40					
45		45					
50		50					
55		55					
60		60					
K6005 -10 x 16	M10	16	16	16	7	7	
20		20		20			
25		25		25			
30		30		26			
35		35					
40		40					
45		45					
50		50					
55		55					
60		60					
K6005 -12 x 20	M12	20	18	24,7	7	8	
25		25					
30		30					
35		35					
40		40					
45		45					
50		50					
55		55					
60		60					