

**K4045 Hochleistungs Kernstift,  
mit zylindrischem Kopf**

**Beryllium-free copper,  
with cylindrical head**

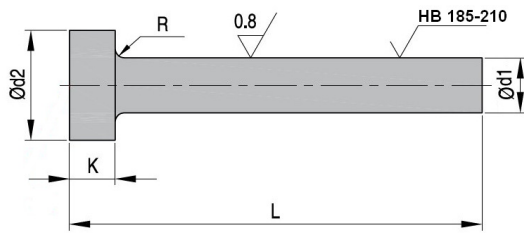

Material: Berylliumfreie Spezial Kupferlegierung

Material: Special copper alloy, beryllium free

DIN ISO 6751, Typ A

P= Stück / Normpackung // Pieces/ standard pack

Bestellbeispiel / Order example: d1=1,5mm; L=100mm

Bestell-Nummer / Order number: **K4045-1,5x100**

d1 g6	100	160	200	L +2				P	d2 0/-0,2	K 0/-0,05	R 0/+0,2		
				250	315	400	500						
2,0								10	4,0	2,0	0,2		
2,5									5,0		0,3		
2,7									6,0	3,0			
3,0													
3,2													
3,5									7,0				
3,7													
4,0								5	8,0	5,0	0,5		
4,2									10,0				
4,5													
5,0													
5,2													
6,0									12,0				
6,2													
7,0													
8,0									14,0				
8,2													
10,0								16,0	7,0	0,8			
12,0													
14,0													
16,0								3	22,0				