

K4030 Auswerferstift,
mit zylindrischem Kopf, Typ TA

Ejector pin,
with cylindrical head, type TA

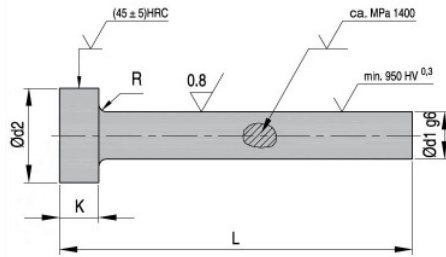

Material: WAS / badnitriert

Material: hot-working steel / bath nitrided

Max. Temp: 500-550 °C

DIN 1530 / ISO 6751

P= Stück / Normpackung // Pieces/ standard pack

Bestellbeispiel / Order example: d1=1,5mm; L=100mm

Bestell-Nummer / Order number: **K4030-1,5x100**

d1	L +2											P	d2 0/-0,2	K 0/-0,05	R 0/+0,2			
	100	125	160	200	250	315	400	500	630	800	1000							
1,5													20	3,0	1,5	0,2		
2,0													10	4,0	2,0	0,3		
2,2												5,0		3,0				
2,5												6,0						
2,7												7,0						
3,0												8,0						
3,2												10,0						
3,5												12,0			5,0	0,5		
3,7												14,0			5	7,0	0,8	
4,0												16,0						
4,2												18,0						
4,5												22,0						
5,0												24,0						
5,2												26,0	8,0	1,0				
5,5												32,0	10,0					
6,0												3	10,0	1,0				
6,2																		16,0
6,5																		18,0
7,0															22,0			
8,0															24,0			
8,2															26,0	8,0	1,0	
8,5															32,0	10,0		
9,0															3	10,0	1,0	
10,0																		16,0
10,2																		18,0
10,5												22,0						
11,0												24,0						
12,0												26,0	8,0	1,0				
12,2												32,0	10,0					
12,5												3	10,0	1,0				
14,0																		16,0
16,0																		18,0
18,0															22,0			
20,0															24,0			
25,0															26,0	8,0	1,0	
															32,0	10,0		