

K7140 Schlauchtüllenverlängerung,
ohne Gewinde mit freiem Durchgang

Extension tube,
without thread and valve

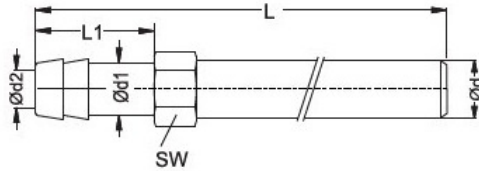

P= Stück / Normpackung // Pieces/ standard pack

Bei optionaler Bestellung bitte Kennbuchstaben hinzufügen:
For optional orders please add the options index end of the order no.:
(Beispiel/example: K7140-d1xL1-Cr)

Material: **Standardversion / Standard version**

Grundkörper: Messing / Body: Brass

Temp: -20°C-+200°C (-40°F - +390°F)

Betriebsdruck / Working pressure: p (bar)

Optionen / Options:

Verchromt / Chrome plated – Index: -Cr

Vernickelt / Nickel plated – Index: -Ni

Edelstahl / Stainless Steel – Index: -S

p	d	d2	SW	L1	P	d1	L	 Bestellnummer Order Number ohne Ventil / without Valve
(bar)	(mm)	(mm)	(mm)	(mm)		(mm)	(mm)	
0-20	10	6	11	25	10	9	120	K7140- 9x120
							240	K7140- 9x240
							360	K7140- 9x360
	14	9	15	33		13	150	K7140-13x150
							300	K7140-13x300
							450	K7140-13x450
	21	13	22	38		19	500	K7140-19x500