

**K7025 Sicherheitsschnellkupplung mit Schlauchtülle,**  
gerade Ausführung, mit Ventil oder freiem Durchgang

**MSTBtec<sup>2</sup>**

**Safety quick release coupling with hose nipple,**  
straight design, with and without valve

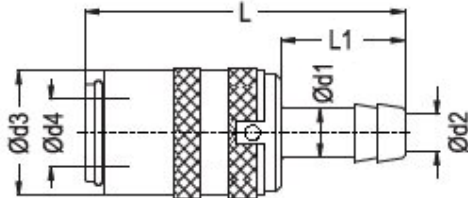

P= Stück / Normpackung // Pieces/ standard pack

Material: **Standardversion / Standard version**

Kupplungsgrundkörper: Messing / Coupler Body: Brass

Hülse: Messing / Sleeve: Brass

Ventil: Messing / Valve: Brass

Feder: Edelstahl / Spring: Stainless Steel

Sprengring: Edelstahl / Locking O-Ring: Stainless Steel

Kugeln: Edelstahl V-/ Balls: Stainless Steel

Betriebsdruck / Working pressure: p (bar)



Optionen / Options:

Verchromt / Chrome plated – Index: -Cr

Vernickelt / Nickel plated – Index: -Ni

Edelstahl / Stainless Steel – Index: -S

Bei optionaler Bestellung bitte Kennbuchstaben hinzufügen:  
For optional orders please add the options index end of the order no.:  
( Beispiel/example: K7025-d1-d4-V-Cr)

p	d2	d3	L	L1	P	d1	d4	 Bestellnummer Order Number Mit Ventil / with Valve	 Bestellnummer Order Number ohne Ventil / without Valve
(bar)	(mm)	(mm)	(mm)	(mm)		(mm)	(mm)		
0 - 10	2,7	10	35	13,5	10	5	5	K7025-05-05-V	K7025-05-05
	4,5	17	46	17,0		6	9	K7025-06-09-V	K7025-06-09
	6					8		K7025-08-09-V	K7025-08-09
						9		K7025-09-09-V	K7025-09-09
						10		K7025-10-09-V	K7025-10-09
0 - 15			52	23		13		K7025-13-09-V	K7025-13-09
	8	23	60			10	13	K7025-10-13-V	K7025-10-13
	10					13		K7025-13-13-V	K7025-13-13
0 - 20	13	31	90	32		19	19	K7025-19-19-V	K7025-19-19

**Dauertemperatur / Long-term service temperature**

K7025	Standard	
	Medium	Max. C°
	Öl / Oil	160
	Wasser / Water	120

K7026	Hochtemperatur High temperature	
	Medium	Max. C°
	Öl / Oil	200
	Wasser / Water	160

K7027	Höchsttemperatur High of temperature	
	Medium	Max. C°
	Öl / Oil	300
	Wasser / Water	250

**MSTBtec<sup>2</sup>**

Jägerstrasse 30  
58091 Hagen

Tel.: +49 (0) 2331 / 186388-0  
Fax: +49 (0) 2331 / 186388-9

info@mstbtec.de  
www.mstbtec.de