

Ejector rod

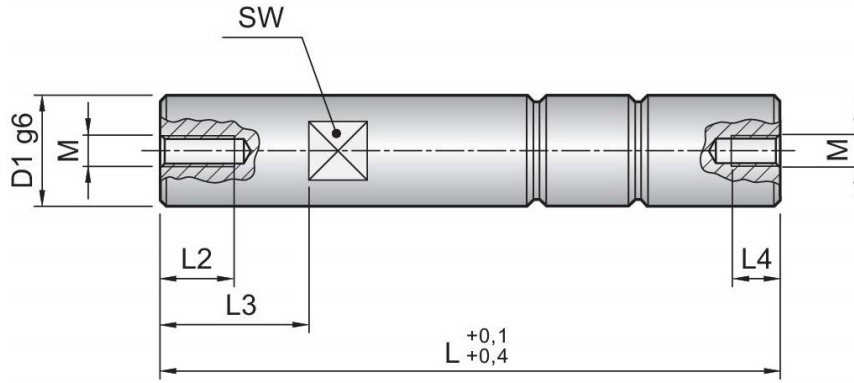

Material: 1.7131 / 61-63 HRC

| Best.Nr. Order No | D1 | L | L2 | L3 | L4 | M | SW |
|----------------------|----|-----|----|----|----|-----|----|
| K3050-10x060 | 10 | 60 | 16 | 12 | 9 | M6 | 8 |
| K3050-10x080 | | 80 | | | | | |
| K3050-10x100 | | 100 | | | | | |
| K3050-10x120 | | 120 | | | | | |
| K3050-10x140 | | 140 | | | | | |
| K3050-10x160 | | 160 | | | | | |
| K3050-14x060 | 14 | 60 | 25 | 14 | 17 | M8 | 12 |
| K3050-14x070 | | 70 | | | | | |
| K3050-14x080 | | 80 | | | | | |
| K3050-14x100 | | 100 | | | | | |
| K3050-14x120 | | 120 | | | | | |
| K3050-14x140 | | 140 | | | | | |
| K3050-14x160 | | 160 | | | | | |
| K3050-14x180 | | 180 | | | | | |
| K3050-14x200 | | 200 | | | | | |
| K3050-14x300 | | 300 | | | | | |
| K3050-18x070 | 18 | 70 | 30 | 16 | 20 | M10 | 14 |
| K3050-18x080 | | 80 | | | | | |
| K3050-18x100 | | 100 | | | | | |
| K3050-18x120 | | 120 | | | | | |
| K3050-18x140 | | 140 | | | | | |
| K3050-18x160 | | 160 | | | | | |
| K3050-18x180 | | 180 | | | | | |
| K3050-18x200 | | 200 | | | | | |
| K3050-18x220 | | 220 | | | | | |
| K3050-18x240 | | 240 | | | | | |
| K3050-18x300 | | 300 | | | | | |
| K3050-20x070 | 20 | 70 | 30 | 18 | 20 | M12 | 17 |
| K3050-20x080 | | 80 | | | | | |
| K3050-20x100 | | 100 | | | | | |
| K3050-20x120 | | 120 | | | | | |
| K3050-20x140 | | 140 | | | | | |
| K3050-20x160 | | 160 | | | | | |
| K3050-20x180 | | 180 | | | | | |

| Best.Nr. Order No | D1 | L | L2 | L3 | L4 | M | SW |
|----------------------|----|-----|----|----|----|-----|----|
| K3050-20x200 | 20 | 200 | 30 | 18 | 20 | M12 | 17 |
| K3050-20x220 | | 220 | | | | | |
| K3050-20x240 | | 240 | | | | | |
| K3050-20x340 | | 340 | | | | | |
| K3050-24x070 | 24 | 70 | 35 | 22 | 25 | M12 | 19 |
| K3050-24x080 | | 80 | | | | | |
| K3050-24x100 | | 100 | | | | | |
| K3050-24x120 | | 120 | | | | | |
| K3050-24x140 | | 140 | | | | | |
| K3050-24x160 | | 160 | | | | | |
| K3050-24x180 | | 180 | | | | | |
| K3050-24x200 | | 200 | | | | | |
| K3050-24x240 | | 240 | | | | | |
| K3050-24x260 | | 260 | | | | | |
| K3050-24x380 | | 380 | | | | | |
| K3050-30x100 | 30 | 100 | 45 | 28 | 30 | M16 | 24 |
| K3050-30x120 | | 120 | | | | | |
| K3050-30x140 | | 140 | | | | | |
| K3050-30x160 | | 160 | | | | | |
| K3050-30x180 | | 180 | | | | | |
| K3050-30x220 | | 220 | | | | | |
| K3050-30x260 | | 260 | | | | | |
| K3050-30x300 | | 300 | | | | | |
| K3050-30x340 | | 340 | | | | | |
| K3050-340x160 | 40 | 160 | 55 | 36 | 35 | M20 | 36 |
| K3050-340x180 | | 180 | | | | | |
| K3050-340x200 | | 200 | | | | | |
| K3050-340x220 | | 220 | | | | | |
| K3050-340x240 | | 240 | | | | | |
| K3050-340x260 | | 260 | | | | | |
| K3050-340x300 | | 300 | | | | | |
| K3050-340x340 | | 340 | | | | | |
| K3050-340x380 | | 380 | | | | | |