

**K7150 Stecknippel mit Schlauchtülle "Push-to-Lock",
mit Aussengewinde und freiem Durchgang**

**Hose nipple "Push-to-Lock",
With outside thread and without valve**

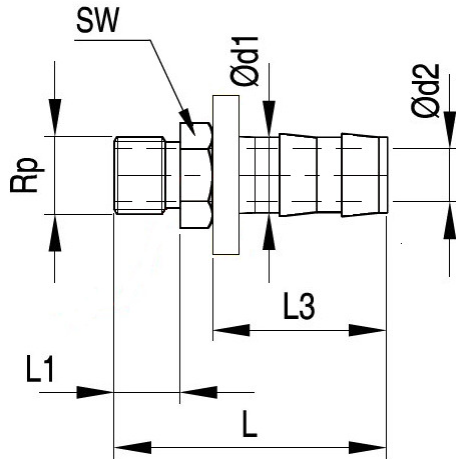

Material: **Standardversion / Standard version**

Kupplungsgrundkörper: Messing / Coupler Body: Brass

Temp: -20°C-+200°C (-40°F - +390°F)

P= Stück / Normpackung // Pieces/ standard pack

d2 (mm)	L (mm)	L1 (mm)	L3 (mm)	SW (mm)	d1 (mm)	P	Rp (mm)	 Bestellnummer Order Number ohne Ventil / without Valve
6	39	9	24	17	10	10	BSP 1/8"	K7150- BSP 1/8
							M10x1,0	K7150- M10x1,0
9	45	11	28		12,7		M14x1,5	K7150- M14x1,5
							BSP 1/4"	K7150- BSP 1/4
10	49	14		19			BSP 3/8"	K7150- BSP 3/8
				22			BSP 1/2"	K7150- BSP 1/2