

K7120 Verlängerungsrippel,
mit ablängbarem Gewinde und freiem Durchgang

Extension nipple,
thread can be cut as required and without valve

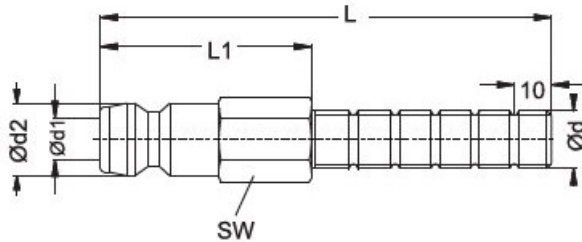

P= Stück / Normpackung // Pieces/ standard pack

Bei optionaler Bestellung bitte Kennbuchstaben hinzufügen:
For optional orders please add the options index end of the order no.:
(Beispiel/example: K7120-d2-d-Cr)

Material: **Standardversion / Standard version**

Grundkörper: Messing / Body: Brass

Ventil: Messing / Valve: Brass

Feder: Edelstahl / Spring: Stainless Steel

Temp: -20°C-+200°C (-40°F - +390°F)

Betriebsdruck / Working pressure: p (bar)

Optionen / Options:

Verchromt / Chrome plated – Index: -Cr

Vernickelt / Nickel plated – Index: -Ni

Edelstahl / Stainless Steel – Index: -S

p (bar)	d1 (mm)	SW (mm)	L	L1 (mm)	P	d2 (mm)	d (mm)	 Bestellnummer Order Number ohne Ventil / without Valve
0-10	6	11	100	40	10	9	M10x1,0	K7120-09-M10x1,0
							BSP 1/8"	K7120-09-BSP 1/8
		14					BSP 1/4"	K7120-09-BSP 1/4
		17					M14x1,5	K7120-09-M14x1,5
		BSP 3/8"					K7120-09-BSP 3/8	
0-15	9	14				13	M10x1,0	K7120-13-M10x1,0
							BSP 1/8"	K7120-13-BSP 1/8
							BSP 1/4"	K7120-13-BSP 1/4
0-20		17					M14x1,5	K7120-13-M14x1,5
							M16x1,5	K7120-13-M16x1,5
							BSP 3/8"	K7120-13-BSP 3/8