

K7100 Nippel mit Aussengewinde,
mit Ventil oder freiem Durchgang

Connecting nipple with outside thread,
with and without valve

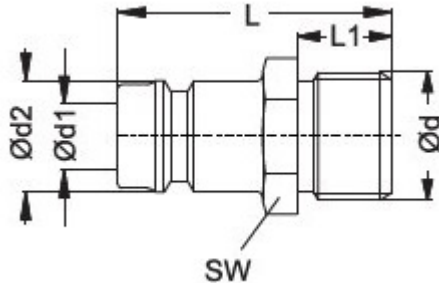

P= Stück / Normpackung // Pieces/ standard pack

Bei optionaler Bestellung bitte Kennbuchstaben hinzufügen:
For optional orders please add the options index end of the order no.:
(Beispiel/example: K7100-d2-d-V-Cr)

Material: **Standardversion / Standard version**

Grundkörper: Messing / Body: Brass

Ventil: Messing / Valve: Brass

Feder: Edelstahl / Spring: Stainless Steel

Temp: -20°C-+200°C (-40°F - +390°F)



Betriebsdruck / Working pressure: p (bar)

Optionen / Options:

Verchromt / Chrome plated – Index: -Cr

Vernickelt / Nickel plated – Index: -Ni

Edelstahl / Stainless Steel – Index: -S

p (bar)	d1 (mm)	SW (mm)	L (mm)	L1 (mm)	P	d2 (mm)	d (mm)	 Bestellnummer Order Number Mit Ventil / with Valve	 Bestellnummer Order Number ohne Ventil / without Valve					
0-10	2,7	9	18	5	20	5	M5x0,50		K7100-5-M5x0,50					
			20	7			M8x0,75		K7100-5-M8x0,75					
			28	5			M5x0,50	K7100-5-M5x0,50-V						
			30	7			M8x0,75	K7100-5-M8x0,75-V						
	5 6	11	14	24		20	9	M8x0,75		K7100-9-M8x0,75				
								M10x1,0		K7100-9-M10x1,0				
								M10x1,5		K7100-9-M10x1,5				
								BSP 1/8"		K7100-9-BSP 1/8				
								BSP 1/4"		K7100-9-BSP 1/4				
									K7100-9-BSP 1/4-V					
								M14x1,5		K7100-9-M14x1,5				
									K7100-9-M14x1,5-V					
				BSP 3/8"				K7100-9-BSP 3/8						
					K7100-9-BSP 3/8-V									
		0-15	9	14	24			7	20	13	BSP 1/8"		K7100-13-BSP 1/8	
					26			9			M10x1,0		K7100-13-M10x1,0	
					M10x1,5		K7100-13-M10x1,5							
					M12x1,5		K7100-13-M12x1,5							
					BSP 1/4"		K7100-13-BSP 1/4							
						K7100-13-BSP 1/4-V								
					30	12	M14x1,5				K7100-13-M14x1,5			
					26	9		K7100-13-M14x1,5-V						
					30	12	M16x1,5				K7100-13-M16x1,5			
								K7100-13-M16x1,5-V						
					17	9	BSP 3/8"				K7100-13- BSP 3/8			
								K7100-13-BSP 3/8-V						
						26	9	BSP 1/2"				K7100-13-BSP 1/2		
						30	12							
0-20	13				22	51	16	20			19		K7100-19-BSP 1/2-V	K7100-19-BSP 1/2
					27							M14x1,5	K7100-19-M14x1,5-V	K7100-19-M14x1,5
					BSP 3/4"	K7100-19-BSP 3/4-V	K7100-19- BSP 3/4							