

**K7090 Adapternippel,  
mit freiem Durchgang**

**Adapter nipple,  
without valve**

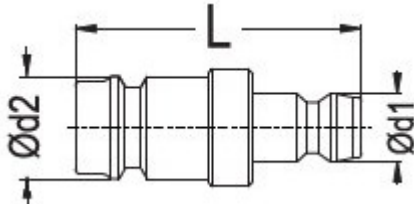

P= Stück / Normpackung // Pieces/ standard pack

Bei optionaler Bestellung bitte Kennbuchstaben hinzufügen:  
For optional orders please add the options index end of the order no.:  
( Beispiel/example: K7090-d1-d2-Cr)

Material: **Standardversion / Standard version**

Grundkörper: Messing / Body: Brass

Ventil: Messing / Valve: Brass

Feder: Edelstahl / Spring: Stainless Steel

Temp: -20°C-+200°C (-40°F - +390°F)

Betriebsdruck / Working pressure: p (bar)

Optionen / Options:

Verchromt / Chrome plated – Index: -Cr

Vernickelt / Nickel plated – Index: -Ni

Edelstahl / Stainless Steel – Index: -S

p (bar)	L (mm)	P	d1 (mm)	d2 (mm)	 <b>Bestellnummer Order Number ohne Ventil / without Valve</b>
0-10	32	20	9	9	K7090-09-09
	34			13	K7090-09-13
0-15	40		13	13	K7090-13-13