

**K7020 Schnellkupplung mit Schlauchtülle, "Push-to-Lock"**  
90° Ausführung, mit Ventil oder freiem Durchgang

**Quick release coupling with hose nipple, "Push-to-Lock"**  
90° design, with and without valve

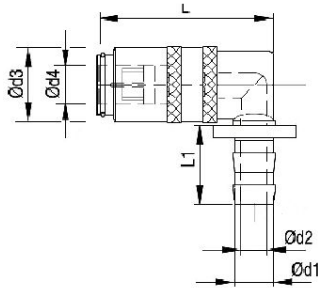

Material: **Standardversion / Standard version**

Kupplungsgrundkörper: Messing / Coupler Body: Brass  
Hülse: Messing / Sleeve: Brass  
Ventil: Messing / Valve: Brass  
Feder: Edelstahl / Spring: Stainless Steel  
Sprengling: Edelstahl / Locking O-Ring: Stainless Steel  
Kugeln: Edelstahl V-/ Balls: Stainless Steel



Betriebsdruck / Working pressure: p (bar)

Optionen / Options:

Verchromt / Chrome plated – Index: -Cr  
Vernickelt / Nickel plated – Index: -Ni  
Edelstahl / Stainless Steel – Index: -S

P= Stück / Normpackung // Pieces/ standard pack

Bei optionaler Bestellung bitte Kennbuchstaben hinzufügen:  
For optional orders please add the options index end of the order no.:  
( Beispiel/example: K7010-d1-d4-V-Cr)

p (bar)	d2 (mm)	d3 (mm)	L (mm)	L1 (mm)	P	d1 (mm)	d4 (mm)	 <b>Bestellnummer Order Number Mit Ventil / with Valve</b>	 <b>Bestellnummer Order Number ohne Ventil / without Valve</b>
0 - 15	7,5	17	42	24	10	10	9	K7020-10-09-V	K7020-10-09
0 - 10	10	23	52	28		13	13	K7020-13-13-V	K7020-13-13

**Dauertemperatur / Long-term service temperature**

K7020	Standard	
	Medium	Max. C°
	Öl / Oil	160
	Wasser / Water	120

K7021	Hochtemperatur High temperature	
	Medium	Max. C°
	Öl / Oil	200
	Wasser / Water	160

K7022	Höchsttemperatur High of temperature	
	Medium	Max. C°
	Öl / Oil	300
	Wasser / Water	250