

K3045 Führungbolzen ohne Bund,
für Kugelführungen

MSTBtec²

Guide pin without collar,
für ball guide units

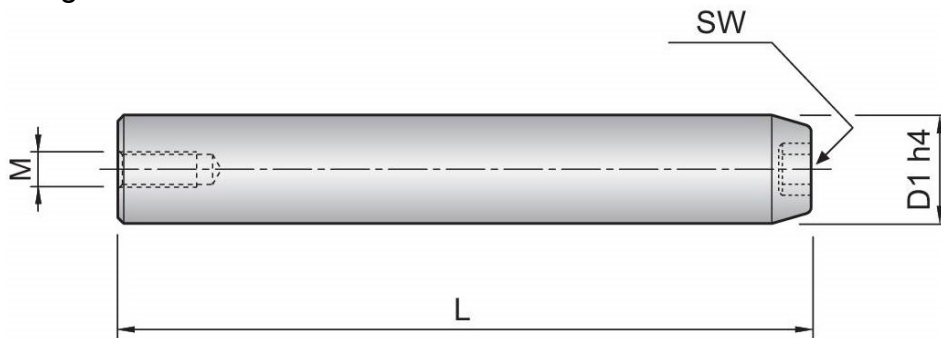

Material: 1.7131 / 61-63 HRC

Best.Nr. Order No	D1	L	M	SW
K3045 -10 x 060	10	60	M8	4
K3045 -10 x 080		80		
K3045 -10 x 100		100		
K3045 -10 x 120		120		
K3045 -10 x 140		140		
K3045 -12 x 080	12	80	M8	5
K3045 -12 x 100		100		
K3045 -12 x 120		120		
K3045 -12 x 140		140		
K3045 -12 x 160		160		
K3045 -18 x 080	18	80	M10	6
K3045 -18 x 100		100		
K3045 -18 x 120		120		
K3045 -18 x 140		140		
K3045 -18 x 160		160		
K3045 -18 x 180		180		
K3045 -18 x 200		200		
K3045 -24 x 100	24	100	M12	8
K3045 -24 x 120		120		
K3045 -24 x 140		140		
K3045 -24 x 160		160		
K3045 -24 x 180		180		
K3045 -24 x 200		200		
K3045 -30 x 140	30	140	M16	8
K3045 -30 x 160		160		
K3045 -30 x 180		180		
K3045 -30 x 200		200		
K3045 -30 x 250		250		

MSTBtec²

Jägerstrasse 30
58091 Hagen

Tel.: +49 (0) 2331 / 186388-0
Fax. +49 (0) 2331 / 186388-9

info@mstbtec.de
www.mstbtec.de