

**K3030 Schrägbolzen,
mit konischem Bund (18°)**

**Inclined pin,
with conical collar (18°)**

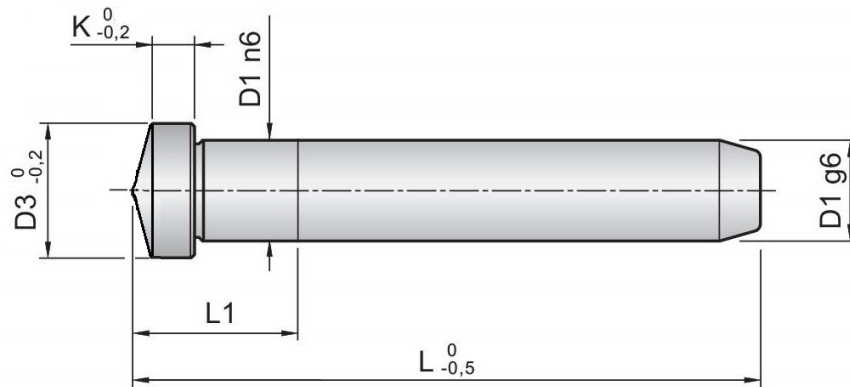

Material: 1.7131 / 61-63 HRC

Best.Nr. Order No	D1	L	L1	D3	K
K3030-14x060	14	60	17	17	3
K3030-14x070		70			
K3030-14x080		80			
K3030-14x090		90			
K3030-14x100		100			
K3030-14x110		110			
K3030-14x120		120			
K3030-14x140		140			
K3030-14x160		160			
K3030-14x180		180			
K3030-14x200		200			
K3030-16x060	16	60	22	19	3
K3030-16x070		70			
K3030-16x80		80			
K3030-16x90		90			
K3030-16x100		100			
K3025-16x110		110			
K3030-16x120		120			
K3030-16x140		140			
K3030-16x160		160			
K3030-16x180		180			
K3030-16x200		200			
K3030-16x220		220			
K3030-16x240		240			
K3030-18x060	18	60	22	21	3
K3030-18x070		70			
K3030-18x080		80			
K3030-18x090		90			

Best.Nr. Order No	D1	L	L1	D3	K
K3030-18x100	18	100	22	21	3
K3030-18x110		110			
K3030-18x120		120			
K3030-18x140		140			
K3030-18x160		160			
K3030-18x180		180			
K3030-18x200		200			
K3030-18x220		220			
K3030-18x240		240			
K3030-18x260		260			
K3030-20x080	20	80	22	23	4
K3030-20x090		90			
K3030-20x100		100			
K3030-20x110		110			
K3030-20x120		120			
K3030-20x140		140			
K3030-20x160		160			
K3030-20x180		180			
K3030-20x200		200			
K3030-20x220		220			
K3030-20x240		240			
K3030-20x260		260			
K3030-20x280		280			
K3030-22x060	22	60	22	25	4
K3030-22x080		80			
K3030-22x100		100			
K3030-22x120		120			
K3030-22x140		140			

Best.Nr. Order No	D1	L	L1	D3	K
K3030-22x160	22	160	27	25	10
K3030-22x180		180			
K3030-22x200		200			
K3030-22x220		220			
K3030-22x240		240			
K3030-22x280		280			
K3030-24x080	24	80	27	27	4
K3030-24x100		100			
K3030-24x120		120			
K3030-24x140		140			
K3030-24x160		160			
K3030-24x180		180			
K3030-24x200		200			
K3030-24x220		220			
K3030-24x240		240			
K3030-24x280		280			
K3030-24x300		300			
K3030-30x100	30	100	36	35	5
K3030-30x120		120			
K3030-30x140		140			
K3030-30x160		160			
K3030-30x180		180			
K3030-30x200		200			
K3030-30x220		220			
K3030-30x240		240			
K3030-30x280		280			
K3030-30x320		320			
K3030-30x360		360			